

# KSS Series Subminiature Side Actuated Tact Switch for SMT



## Features/Benefits

- Low profile of 1.6 mm
- Excellent tactile feel
- High shear force
- Range of actuation forces
- Large flat top
- Redundant contacts option
- Date code marking

## Typical Applications

- Cellular phone
- PDA, pagers
- Industrial electronics
- Health diagnostic electronics

B  
Tactile Switches

## Specification

FUNCTION: momentary action  
CONTACT ARRANGEMENT: N.O.  
TERMINALS: Gullwing & 3-Way type for SMT

## Mechanical

Type	Operating force Newtons (grams)	Operating life (operations)	Travel
KSS221G	2.0 (200) ± 25%	100,000	0,3 ± 0,15
KSS231G	2.5 (250) ± 20%	100,000	0,3 ± 0,10
KSS233W	2.5 (200) ± 25%	100,000	0,3 ± 0,15
KSS241G	4.0 (400) ± 25%	100,000	0,3 ± 0,15

## Electrical

	Silver	Gold
MAXIMUM POWER:	1 VA	0.2 VA
MAXIMUM VOLTAGE:	50 VDC	50 VDC
MAXIMUM CURRENT:	50 mA	10 mA
MINIMUM CURRENT:	1 mA	1 mA

DIELECTRIC STRENGTH: ≥ 250 VDC  
CONTACT RESISTANCE: ≤ 100 mΩ  
INSULATION RESISTANCE (100 VDC): ≥ 10<sup>9</sup> Ω  
BOUNCE TIME: ≤ 3 ms

## Environmental

	Silver	Gold
OPERATING TEMPERATURE:	-40°C to 85°C	-40°C to 125°C
STORAGE TEMPERATURE:	-55°C to 85°C	-55°C to 125°C

## Process

SOLDERING: Infrared reflow in accordance with CECC00802

## Packaging

Switches are delivered in tape and reels of 3,000 pieces. The reel diameter is 330mm (12.992 x .15). The tape dimensions conform to the EIA-RS-481 and CE-2863 norms.

**NOTE:** Part numbers listed above do not represent all possible configurations. For information on specific and custom switches, consult Customer Service Center.

## How To Order

Our easy build-a-switch concept allows you to mix and match options to create the switch you need. To order, select desired option from each category and place it in the appropriate box.

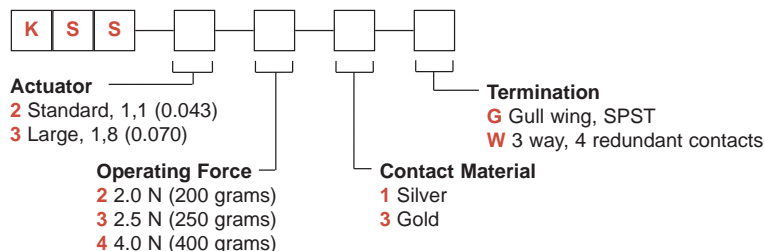

# KSS Series Subminiature Side Actuated Tact Switch for SMT

SERIES

KSS



KSS221G

Each piece is date code printed:  
1st Line: 9308 = Year 1999, 308 day in the year  
2nd Line: 221XA = Manufacturing code.

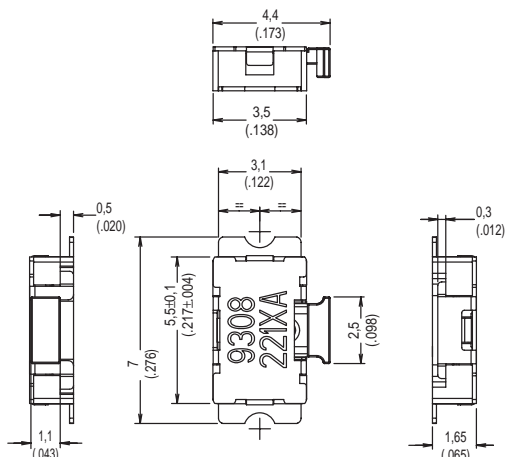

ACTUATOR

**2** STANDARD, 1,1 (0.043)

**3** LARGE, 1,8 (0.070)

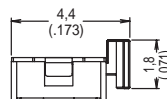
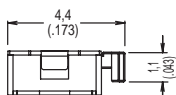

OPERATING FORCE

OPTION CODE	OPERATING FORCE
<b>2</b>	2.0 N (200 grams)
<b>3</b>	2.5 N (250 grams)
<b>4</b>	4.0 N (400 grams)

CONTACT MATERIAL

OPTION CODE	MATERIAL
<b>1</b>	SILVER
<b>3</b>	GOLD

TERMINATION

**G** GULLWING

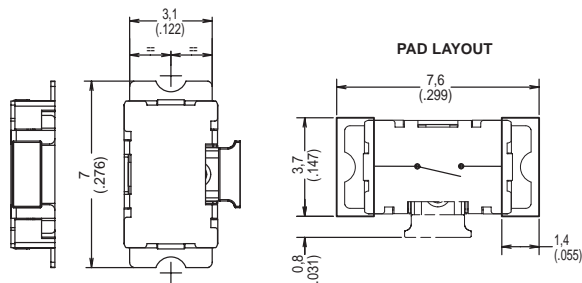

**W** 3 WAY, 4 REDUNDANT CONTACTS

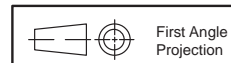
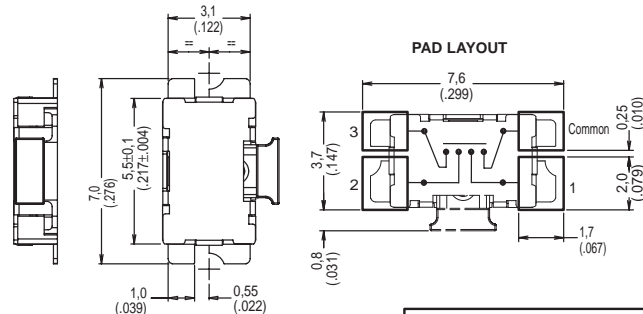

Dimensions are shown: mm (inch)  
Dimensions subject to change

# KSS Series Subminiature Side Actuated Tact Switch for SMT

## TAPE & REEL

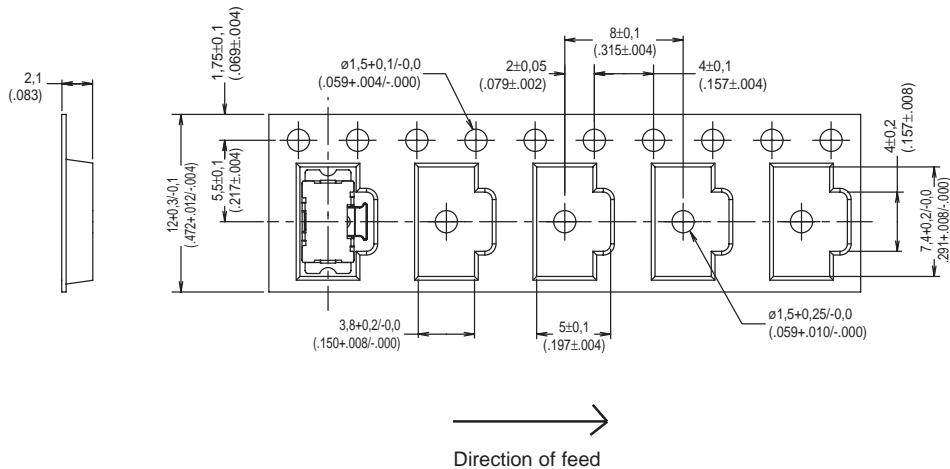

B

Tactile Switches